

BATTERY MELTER



Operating Instructions: Insert 3x AA 1.5V batteries. Remove the protective cover from the tip. Ensure that the tip is fitted correctly. Move the "ON/OFF" switch to the "ON" position. Hold the melter like a ballpoint pen. Press the round "Power" button on top of the "ON/OFF" switch for approx. 30 secs., until the tip has reached the desired operating temperature. In order to save energy, press the "Power" button only during melting. Put down hot melter in upright condition, when not being used. After melting, move switch to the OFF position and replace protective cap after tip has cooled down.

IMPORTANT: Do not press down melter tip while filling, tip could break!
Cleaning: After each use, clean the melter tip with a cloth.

Safety Notes: Always store melter with cap fitted and ensure "ON/OFF" switch is set to "OFF" position. Tip turns hot during operation. Do not touch the tip during operation. Never bring the tool into contact with water. After operation, allow tip to cool down before storage. Always turn off melter after operation, while pushing the switch into the "OFF" position.

SPECIAL FILLERS APPLICATOR

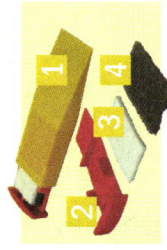

The Special Fillers Applicator consists of:

- 1) Plastic body with grooves to remove surplus Hardwax filler
- 2) Red cleaning comb to clean the grooves
- 3) Sanding & Polishing Cloth
- 4) Grey Sanding Pad

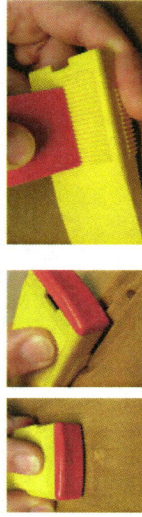

Keeping the grooves flat to the surface move backwards and forwards over the filled area. Gradually increase pressure until the surplus filler has been removed.

IMPORTANT: Use triangular teeth on flat surfaces and rounded teeth on edges

Drag the cleaning comb over the teeth to remove filler.

HARDWAX



Preparation: Remove any loose particles, burrs or high points using a sharp chisel and choose the appropriate shades of Hardwax (see chart below).



Filling: Melt onto the tip of the heating iron and apply to the affected area. Leave to cool for approximately 1 minute.



Levelling: Keeping the grooves flat to the surface move backwards and forwards over the filled area. Gradually increase pressure until the surplus filler has been removed. **IMPORTANT:** Use triangular teeth on flat surfaces and rounded teeth on edges.



Colour adjustment: You can recreate the grain colour by choosing the darker shade and applying in the direction of the grain pattern. Remove surplus filler as before.

Select the appropriate numbered wax fillers from the list below.

Oak	Irish Oak	Mahogany	Rosewood	White
49601 and 143	96006 and 143	114 and 9005	9005 and 114	

SANDING & POLISHING CLOTH

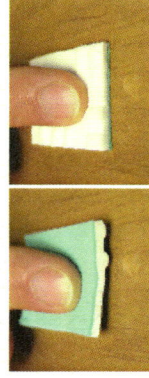

Use the white side of the cloth to dull and the green side to polish the filled area.